

# TC Thermometer Omnigrad TSC 140T

## DIN 43 763, form D

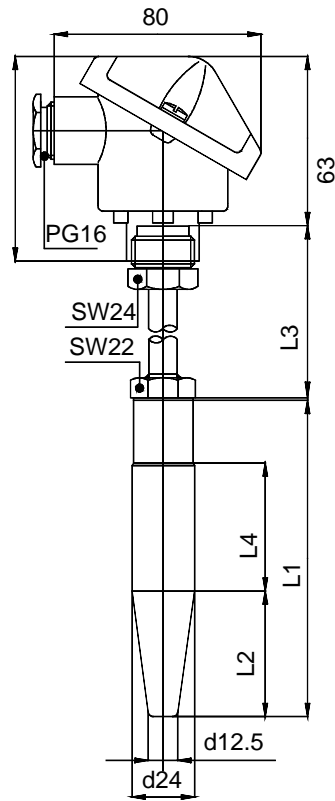

### Description

The thermometer TSC 140T includes a thermowell according to DIN 43 763, form D and a TET 100 E+H Pt 100 inset either with free wires for head transmitter mounting or with a ceramic terminal block. The connection to process is weld-in. The terminal head can be selected from a wide choice of standard items (see the Technical Information TA 20 and the order key).

### Application

The weld-in thermometer TSC 140T is practically suited for heavy duty. It has been designed specially for steam temperature measurement.

### Response time

According to IEC751 in moving water at 0.4 m/s

	T <sub>50</sub>	T <sub>90</sub>
Isolated Junction	11.5 s	25 s

## Technical Data

### Inset

E+H type:  
Sensing element:  
Range:  
Tolerances:

TEC 100 according to DIN 43 735  
Thermocouple type T, J, K Single or Double  
According to type of thermocouple  
According to class 2, DIN IEC 584.2;  
class 1 or 3 acc. to DIN IEC 584.2

### Protection tube

E+H type:  
Standard diameter:  
Process connection:  
Standard material:

According to DIN 43 763 form D  
24mm (root) x12.5 mm( tip )  
For welding  
W 1.4571 - AISI 316 Ti, W 1.7335 - 13CrMo 44  
W 1.7380 - 10CrMo 910  
450 °C / 20 bar; 500 °C / 1 bar (see TI 090T)

Max operating conditions:

### Terminal head

E+H type:  
Protection class :  
Cable connection:

Standard according to DIN 43 729, AI, Din B  
IP 54  
PG 16 with cable gland



# Order Key

## TSC 140T TC Thermometer, Tapered End

Includes a 6 mm mineral insulated inset, a form D DIN thermowell, with process connection for welding, tapered tip and a terminal head.

### Thermowell material

- 8 - Thermowell material 13CrMo44-W1.7355
- 1 - Thermowell material AISI316Ti-W1.4571
- 6 - Thermowell material 10CrMo910-W1.7380

### 100mm thermowell

- 8 - Process material 13CrMo44-W1.7335
- 1 - Process material AISI316Ti-W.14571
- 6 - Process material 10CrMo910-W1.7380

### Price for 100mm thermocouple

- B - 1xTC type K, sheath INCONEL 600-W2.4816
- F - 2xTC type K, sheath INCONEL 600-W2.4816
- H - 1xTC type J, sheath AISI 316-W1.4401
- J - 2xTC type J, sheath AISI 316-W1.4401
- L - 1xTC type T, sheath AISI 316-W1.4401
- M - 2xTC type T, sheath AISI 316-W1.4401
- Y - To specification

### Insertion lengths L1-L2-L3

- CA - 100 mm = L1 (L2= 65 mm - L3=162 mm)
- DA - 140 mm = L1 (L2= 65 mm - L3=162 mm)
- FA - 200 mm = L1 (L2=65 mm - L3=192 mm)
- FB - 200 mm = L1 (L2=125 mm - L3=192 mm)
- GB - 260 mm = L1 (L2=125 mm -L3=192 mm)
- YY - mm = length L to specification

### Type of terminal strip

- 12 - Washer DIN B head, wire length 70 mm
- 13 - Ceramic block, DIN B head, 1xTC
- 14 - Ceramic block, DIN B head, 2xTC

### Hot junction type

- G - Hot junction grounded
- J - Hot junction isolated

### Terminal head M24X1,5 PG 16

- A - TA20A-DIN B, Al
- B - TA20B-DIN B, PA
- C - TA20C-DIN B, Al, i.s
- D - TA20D-Al, for 2 Tx
- P - TA20P - DIN B , Al with high cap

### Built-in 2 wire transmitter

- 0 - Transmitter not built-in
- 1 - Transmitter built-in

TSC 140T

--	--	--	--	--	--	--	--	--	--	--

Complete Order Code

All information is subject to change without notice

### Export Division

Endress+Hauser  
 Instruments International  
 GmbH+Co  
 P.O. Box 2222  
 D-79574 Weil am Rhein  
 Germany  
 Tel. (7621) 9-75-02  
 Fax. (7621) 9-753-45  
 Tx. 7-73-926

Endress+Hauser  
 Nothing beats know-how

